

Product	BPB Plasterboard
System	Steel frame wall system
System Number	TGSL60
Fire Resistance Rating	60/60/60
Plasterboard System	2 Layers 13mm BPB Firestop each side

Framing

Steel stud framing of nominal 92 x 35mm and gauge of 1.15 BMT or SMG. Steel channels are fixed to the ceiling and floor and studs are placed at 600mm centres. There is no end gap between stud ends and channels. Studs are to be fixed to channels top and bottom using 8g screws.

Wall Height

Wall may be maximum 3 metres high with studs at 600mm centres. Walls over 3 metres high must be separately designed for serviceability and structural loading at normal ambient temperatures in accordance with NZS 3604.

Lining

Two layers of 13.0mm BPB Firestop fixed each side. Use full-length sheets where possible.

Fixing

Fix sheets at 200mm centres to perimeter of sheets and 300mm to intermediate studs. Fixings should start at 50mm from top or bottom of the wall. Sheet joints do not need to be staggered between faces on the opposite sides of the frame. Horizontal and vertical fixing permitted. No nogs are required for horizontal fixing provided sheet joints are staggered by at least 400mm between layers. All sheet edges must be made over solid framing.

Insulation

Wall cavities are optionally filled with R 1.8 nominal 75mm fibreglass insulation or equivalent.

Jointing

All fastener heads stopped and all sheet joints reinforced with paper jointing tape to outside layer only and stopped in accordance with AS/NZS 2589.1.

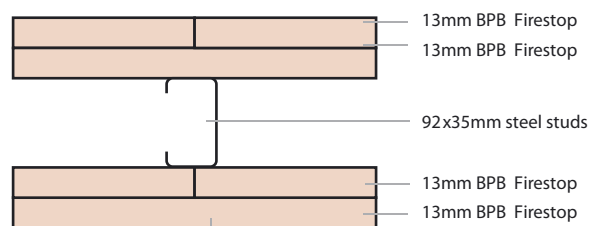

Fasteners	Drywall Screws
	12mm from sheet edge
Inner 13mm	40mm x 6g Bugle head
Outer 13mm	50mm x 7g Bugle head