

Timber frame fire rated systems

Product	BPB Plasterboard
System	Timber frame wall system
System Number	TGTL90a
Fire Resistance Rating	90/90/90
Plasterboard System	1 Inner Layer 16mm BPB Firestop and 1 Outer Layer 16mm BPB Firestop each side

Framing

Timber framing constructed using framing dimensions and height as determined by NZS 3604 stud tables for non-loadbearing walls. Minimum stud size is 75 x 38mm. Studs are placed at 600mm centres maximum. Nogs are at 800mm centres for vertical fixing and at 1200mm centres for horizontal fixing.

Wall Height

Framing dimensions and wall height are determined by NZS 3604 stud tables for loadbearing partitions.

Lining

One inner layer of 16.0mm BPB Firestop and one outer layer of 16.0mm BPB Firestop fixed each side. Use full-length sheets where possible.

Fixing

Fix sheets at 200mm centres to sheet perimeter and 300mm centres to intermediate studs. Horizontal and vertical fixing permitted. All sheet edges must be made over solid framing.

Insulation

Wall cavities are optionally filled with R 1.8 nominal 75mm fibreglass insulation or equivalent.

Jointing

All fastener heads stopped and all sheet joints reinforced with paper jointing tape and stopped in accordance with AS/NZS 2589.1.

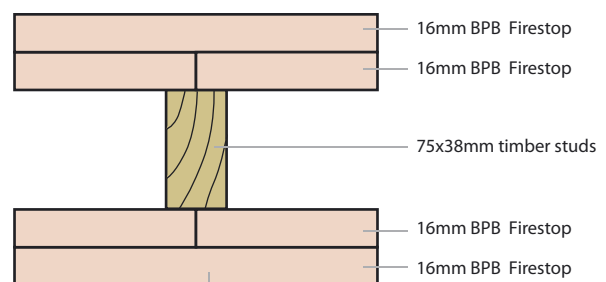

Fasteners	Drywall Screws
	12mm from sheet edge
Inner 16mm	40mm x 6g Bugle head
Outer 16mm	50mm x 7g Bugle head